

Installing Decorative Shade Pulls

Decorative Metal Pull:

To avoid damage to the shade during shipping, the factory does not attach decorative shade pulls. To attach a shade pull, locate the center of the bottom rail and mark lightly with a pencil. Use an awl to punch a hole at the pencil mark. Place the metal plate over the mark and insert the screw eye through the hole of the plate. Screw into the wooden bottom rail through the fabric to secure the ring.

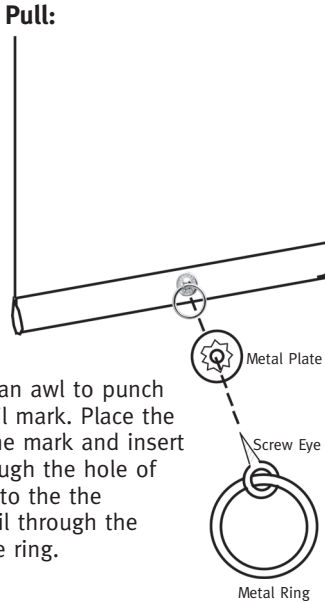

Decorative Pull Ring or Tassel:

To attach a shade pull, locate the center of the bottom rail and mark lightly with a pencil. Use an awl to punch a hole at the pencil mark. Wrap the cord loop around the screw of the Higbee Button. Screw the Higbee Button into the bottom rail through the fabric until the slot on the back of the button is at the bottom of the shade, the cords should hang straight down.

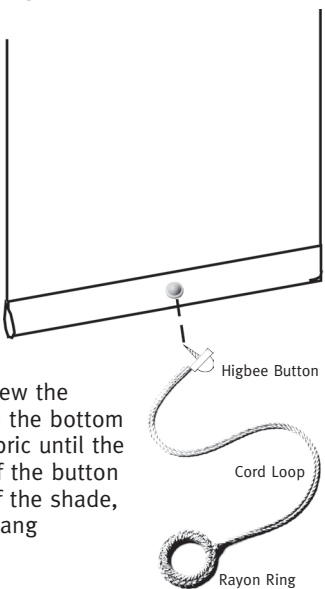

Shade Maintenance

Leveling a Crooked Shade

1. Pull down shade until roller is exposed. Do not pull further to avoid pulling cloth off roller.
2. Stick a 5" strip of masking tape into the roller at opposite side from where it is going crooked. Place as close to edge as possible.
3. Roll up shade. If it is still going crooked:
 - A. If shade is still crooked to the same side, add another strip of tape on top of the first one to and repeat.
 - B. If shade is crooked to the opposite end, tear off about 1" from tape and repeat

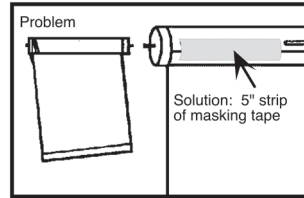

REMEMBER: After making above correction, your hand is still the best guide to rolling a shade straight. Watch the end of the roller as you roll up shade to see if shade is going even.

Adjusting Spring Roller Tension

When shade does not roll up, the spring is too loose.

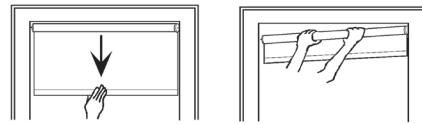

1. Draw the shade about 18 inches and remove it from the brackets.
2. Roll up the shade by hand and replace it in the brackets. Repeat until the proper tension is reached.

When the shade will not stay down, the spring is too tight.

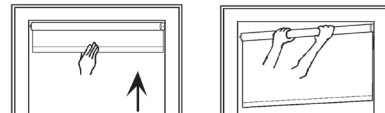

1. Raise the shade all the way up and remove from the brackets
2. Unroll the shade about 18 inches and replace it in the brackets. Repeat until the proper tension is reached.

Shade Maintenance

Wrinkled Shade

Light wrinkles in a shade can be removed by lowering the shade and leaving in this position for 5 to 7 days. The wrinkles will smooth out from the warmth of the sun.

Lifetime Limited Guarantee

B&W Window Fashions warrants that its Horizons products - properly installed in a residential dwelling will be free from defects in materials and workmanship for as long as the original purchaser owns the product.

All fabric colors tend to lose their original intensity over time, and pull cords eventually wear out. This is considered normal wear and tear and is not covered by this guarantee. Abuse and misuse are not covered. Color lots vary and may not exactly match a previously ordered product. Repair is the purchaser's sole remedy under this guarantee.

This guarantee does not cover incidental or consequential damages, freight, installation or service calls (trip charges).

B&W Window Fashions
Waukegan, Illinois

Installation Instructions for

Horizons™
by B&W

Shades of Elegance™ Spring Roller Shades



Congratulations on the purchase of your new Horizons™ Shades of Elegance Roller Shade!

Horizons™
by B&W

Before Installing

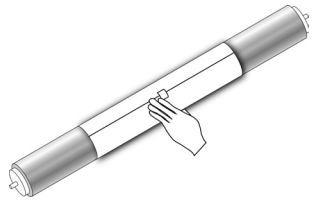

Your new Shades of Elegance™ roller shades are wrapped at the factory with two layers of paper. The final inner paper wrap around the center of the shade is to protect the shade from damage and finger prints during installation. Only pick up the shade with the paper wrap and leave it on until the shade is fully installed up in the window.

Bracket Configurations

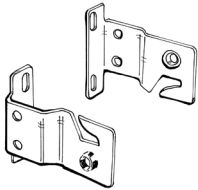

Brackets for Standard Shades

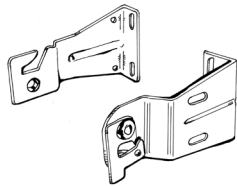

Brackets for Reverse Roll Shades

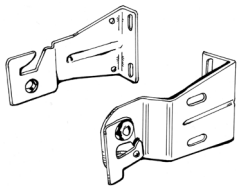

Brackets for Oversized Shades

Standard Shades Instructions

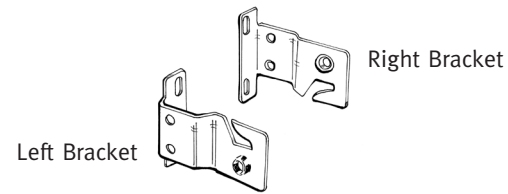

Mounting the Brackets:

- The mounting brackets for standard roller shades are universal and are suitable for side, top or wall mounting. Make sure that the brackets are **perfectly level** with each other.
- For an INSIDE MOUNT allow 1/2" clearance between the top of the frame and the top of the fully rolled shade.
- Always allow a small amount of play between the brackets and the roller ends to ensure proper roller function.

Installing the Shade into Brackets:

Slide the end with the round pin into the the right bracket (Diagram A) and then fit the end with the flat pin into the left bracket (Diagram B).

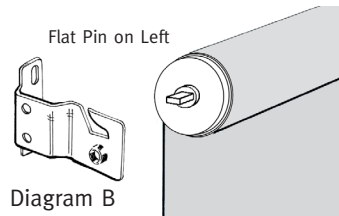
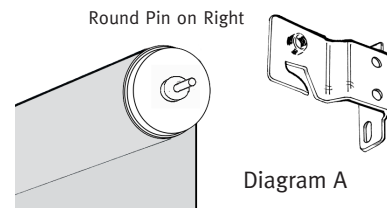

- After the shade is completely installed, carefully remove the paper wrap.

Reverse Roll Instructions

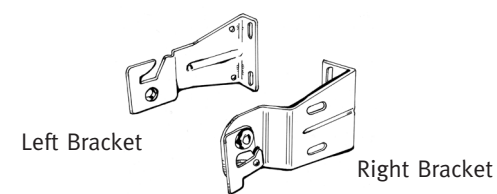

Mounting the Brackets:

- The mounting brackets for reverse roller shades are suitable for side, top or wall mounting. Make sure that the brackets are **perfectly level** with each other.
- For an INSIDE MOUNT allow 1/2" clearance between the top of the frame and the top of the fully rolled shade.
- Always allow a small amount of play between the brackets and the roller ends to ensure proper roller function.

Installing the Shade into Brackets:

Slide the end with the round pin into the the left bracket (Diagram A) and then fit the end with the flat pin into the bottom of the right bracket (Diagram B). Close the swing arm to secure.

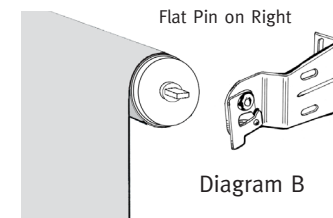
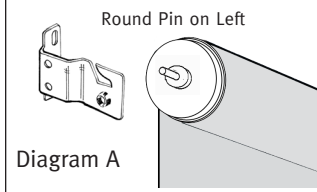

- After the shade is completely installed, carefully remove the paper wrap.

Oversized Shades Instructions

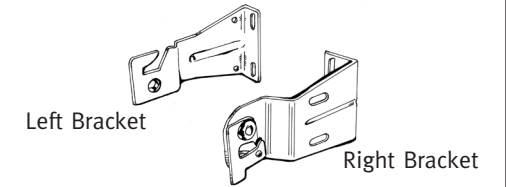

Mounting the Brackets:

- The mounting brackets for oversized roller shades are suitable for side, top or wall mounting. Begin by mounting the left bracket at the shades desired height, because the oversized shades have a flat pin on each end the **right side bracket must be offset by 5/16"**. This allows the slots that accommodate flat pins to line up. For wall or side mount, mount the right side bracket 5/16" **higher** than the left. For ceiling mount, mount the right side bracket 5/16" **in front** of the left bracket.
- For an INSIDE MOUNT allow 1/2" clearance between the top of the frame and the top of the fully rolled shade.
- Always allow a small amount of play between the brackets and the roller ends to ensure proper roller function.

Installing the Shade into Brackets:

Rest the left end with the flat pin in the left bracket (Diagram A) and then fit the right end with the flat pin into the right bracket (Diagram B). Close the swing arm to secure.

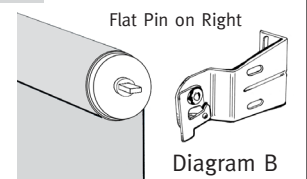
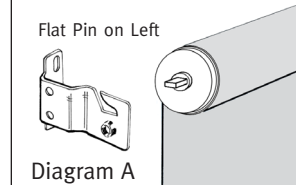

- After the shade is completely installed, carefully remove the paper wrap.